

无线充电器

使用说明书

感谢您购买我公司的多功能无线充电产品,SY-W02141是一款集齐手表,手机,耳机,磁吸功能的无线充电器。

(设备需支持Qi标准)

使用产品前,请仔细阅读说明书

了解无线充设备

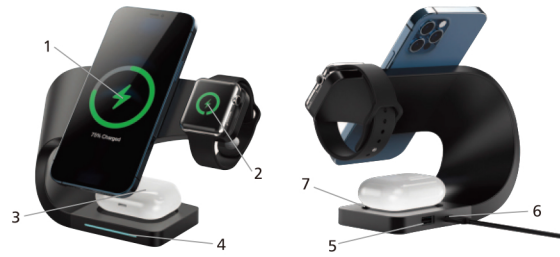

1	15W手机快充	5	USB输出口5W
2	3W手表充(兼容苹果手表系列)	6	Type-C输入口
3	5W耳机充	7	亚克力镜片
4	指示灯		

产品参数

磁吸线圈功率: 5W/7.5W/10W/15W

耳机线圈功率: 5W

USB接口输出功率: 5W

手表功率: 3W

输入电压: 5V/4A 9V/4A

工作指示灯状态说明

- 1、产品接通电源之后,会有三种颜色亮起,分别为红色,绿色,蓝色。500ms后绿色,蓝色灯变红色,进入单红色灯待机状态。
- 2、绿灯对应手机磁吸线圈 5W/7.5W/10W/15W 充电,充电时绿灯亮起,充满灭灯。
- 3、蓝灯对应耳机线圈5W充电时蓝灯亮起,充满灭灯。
- 4、手表充电时,红灯不变。
- 5、当产品检测到手机,耳机部位对不准或者存在异物,则会快闪。

安全须知:

请勿自行拆卸充电器或投入火中、水中,避免造成短路漏电。请勿将充电器在严重高温、潮湿或腐蚀环境下使用,避免损坏电路出现短路或漏电。

保修条款:

- 1、7日内包换:
自产品售出之日起7日内,若产品出现性能故障,并且产品本身及外包装保存完好,无划伤,顾客可以到购买处更换同款车型产品。
- 2、一年保修:
自产品售出之日起12个月内,若产品出现了保修范围内界定的质量问题,顾客可以将产品交到由我公司指定分销商处维修。保修范围产品在正常使用过程中出现不能正常工作或正常使用时出现故障,并经过我公司专业人员认定后可享受我公司的服务承诺。

以下情况不在保修范围内:

- 1、因用户操作不当导致的故障
 - 2、因意外火灾、人为损坏、自行拆卸,拆封标及非本公司授权的维修店修引起的故障。
- 注:因用户操作不当所导致的产品损坏甚至带来危险,我公司一概不承担任何责任。

FC CE RoHS

wireless charger

an instruction manual

Thank you for your purchase of our multi-function wireless charging products,SY-W02141 is a collection of watches, mobile phones, airpod, magnetic absorption function of the wireless charger.

The device must support the Qi standard

Please read the instruction manual carefully before using the product

Learn about wireless charging devices

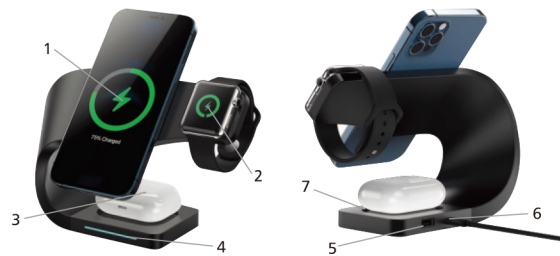

1	15W Phone Output	5	USB output 5W
2	3W Watch Charger (compatible with Apple Watch series)	6	Type-c input port
3	5W Airpods Output	7	Acrylic Lens
4	Indicator light		

Product parameters

Product parameters

Phone Output: 5W/7.5W/10W/15W

Airpods Output: 5W

USB Output: 5W

Iwatch Output: 3W

Input: 5V/4A 9V/4A

Description of working indicator status

1. After the product is switched on, three colors will light up, namely red, green and blue. After 500ms green, the blue light turns red, and the single red light enters standby state.
2. The green light corresponds to Phone wireless charging, the green light is on when charging and off when full
3. The blue light is corresponding to Airpods charging, the blue light is on when charging and off when full.
4. When the watch is charged, the red light remains unchanged.
5. When the product detects the mobile phone, the earphone is not aligned correctly or there is a foreign object, the indicator light will flash quickly

Safety instructions:

Do not remove the charger or put it into fire or water to avoid short circuit and leakage. Do not use the charger in severe high temperature, humidity or corrosive environment to avoid short circuit or leakage.

Warranty terms:

1. Replacement within 7 days:
Within 7 days from the date of product sales, if the product performance fails, and the product itself and the outer packaging are intact and free of scratches, customers can go to the place of purchase to replace the same model product.
2. 1 Year Warranty:
Within 12 months from the date of product sales, if the product has a quality problem within the warranty range, the customer can send the product to our designated dealer for repair. If the products within the warranty range fail to work normally or malfunction during normal use, they can enjoy the service promise of our company after being appraised by our company's professionals.

The following conditions are not covered by the warranty:

1. Failure caused by user's improper operation
2. Due to accidental fire, man-made damage, self dismantling, unsealing and non authorized by the company Right repair shop repair bow trouble.

Note: our company will not accept any damage or even danger caused by improper operation Take any responsibility.

FC CE RoHS